



Common Mode Choke

ET35 Series

ET28Type 1



Dimensions:(mm)

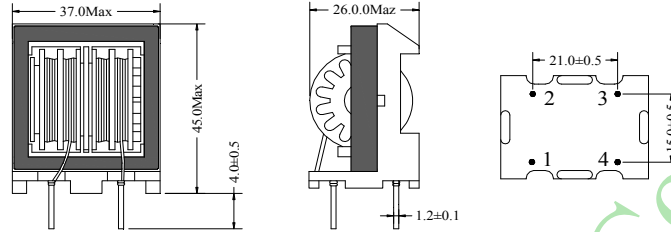

Schematic:

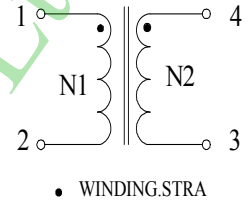

ET28 Type 2



Dimensions:(mm)

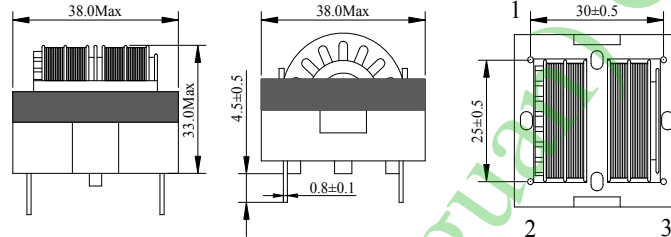

Schematic:

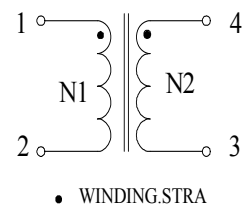

APPLICATIONS:

- EMC suppressors.
- AC line filter.

Feature:

- Line filters suppressing conductive noise ranging from low to high frequencies generated at power supply circuits of the various electronic equipment.
- High safety and reliability .
- Closed magnetic circuit.
- Easy PC board mounting.

ELECTRICAL CHARACTERISTICS:

Part Number	Inductance (mH)Min	DCR Max.(OHM)	Rated Current (A) Max
PZ-ET35-4.7	4.7	0.062	4.00
PZ-ET35-5.6	5.6	0.077	3.50
PZ-ET35-8.2	8.2	0.105	3.00
PZ-ET35-10	10.0	0.140	2.70
PZ-ET35-12	12.0	0.170	2.50
PZ-ET35-15	15.0	0.210	2.20
PZ-ET35-18	18.0	0.230	2.00
PZ-ET35-22	22.0	0.290	1.80
PZ-ET35-33	33.0	0.420	1.50

★Due to the limited space, the catalogue shows the typical specifications only. For more Specific details (characteristics graph, reliability, and others)

★Design to customer requirement

- 1.Test Frequency : 1KHZ/0.25V. Operating temperature : -50 °C to 130 °C
- 2.Rated Current:The current when temperature of coil increases up to Max. $\Delta T=40^{\circ}C$ ($T_a=20^{\circ}C$)
3. Insulation: AC 2000V 1 minute between line & line
- 4.Insulation Resistance: 100 M Ω Min when DC 500V between line & line